

Connecting the antenna adapter

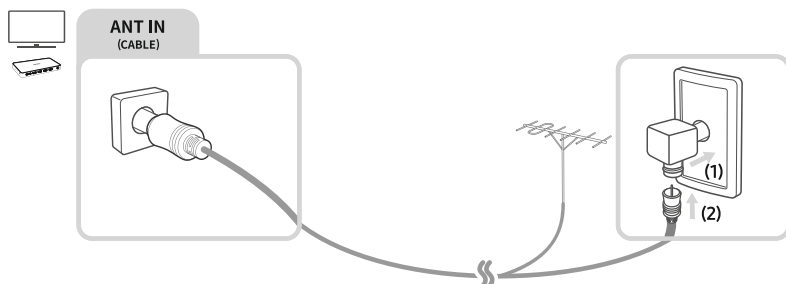

Connect the provided antenna adapter to an antenna terminal on the wall, and then connect the antenna cable, which is connected to ANT IN (CABLE) on the TV, to the antenna adapter.

The connected antenna adapter prevents overload that may occur due to potential difference between the antenna terminal on the wall and the antenna cable, consequently being able to prevent product damage or fire.

- Be sure to use the provided antenna adapter.
- The method for connecting the antenna adapter and the markings on the antenna terminals may differ depending on the model and geographical region.
- If you use the antenna adapter where antenna signals are weak, the screen may become blurry.

IMPORTANT SAFETY PRECAUTIONS

If a television is not positioned in a sufficiently stable location, it can be potentially hazardous due to falling. Many injuries, particularly to children, can be avoided by taking simple precautions such as:

Placing the television on a platform, stand, cabinet, table or other surface which is:

recommended by Samsung or sold with the product; secure and stable;

sufficiently wider in the base than the base measurement of the television;

strong and large enough to support the size and weight of the television.

Positioning the television close to the wall to avoid the possibility of the television falling when pushed.

Ensuring your television is installed by an authorized Samsung installer.

Following the instructions for wall mounting in the installation manual and using the mounting equipment supplied by Samsung.

Placing the television toward the back of the furniture or surface on which it is placed.

Ensuring that the television does not hang over the edge of the furniture or surface on which it is placed.

Not hanging anything from or on the television.

Anchoring both the television and the furniture on which it is placed to a suitable support especially in the case of tall furniture, such as cupboards or bookcases which exceed one meter in height. This can be done by using sturdy brackets, safety straps or mounts that are made specifically for flat screen televisions.

Not placing any material between the television and the furniture on which it is placed.

If the furniture on which the television is placed has drawers, cabinets or shelves under the television, taking steps to prevent children from climbing, such as installing safety latches so the doors cannot be opened.

Keeping pets away from the television.

Educating children about the dangers of climbing on furniture to reach the television or its control.

Failure to take these safety precautions may cause the television to fall from the stand or mounting equipment, causing damage or serious injury.



About the Buttons on the Remote Control

- Use the remote control less than 6 m from the TV. The usable distance may vary with the wireless environmental conditions.
- The images, buttons, and functions of the remote control may differ with the model or geographical area.
- The image of the Remote as shown is for representational purposes only. Actual Remote design, features and functions may vary depending upon the LED model.
- This remote control has Braille points on the Power, Channel, Volume, and Select buttons and can be used by visually impaired persons.
- If you use the remote control that comes with your TV to control another TV, some functions may not operate normally.

